

Mounting stages

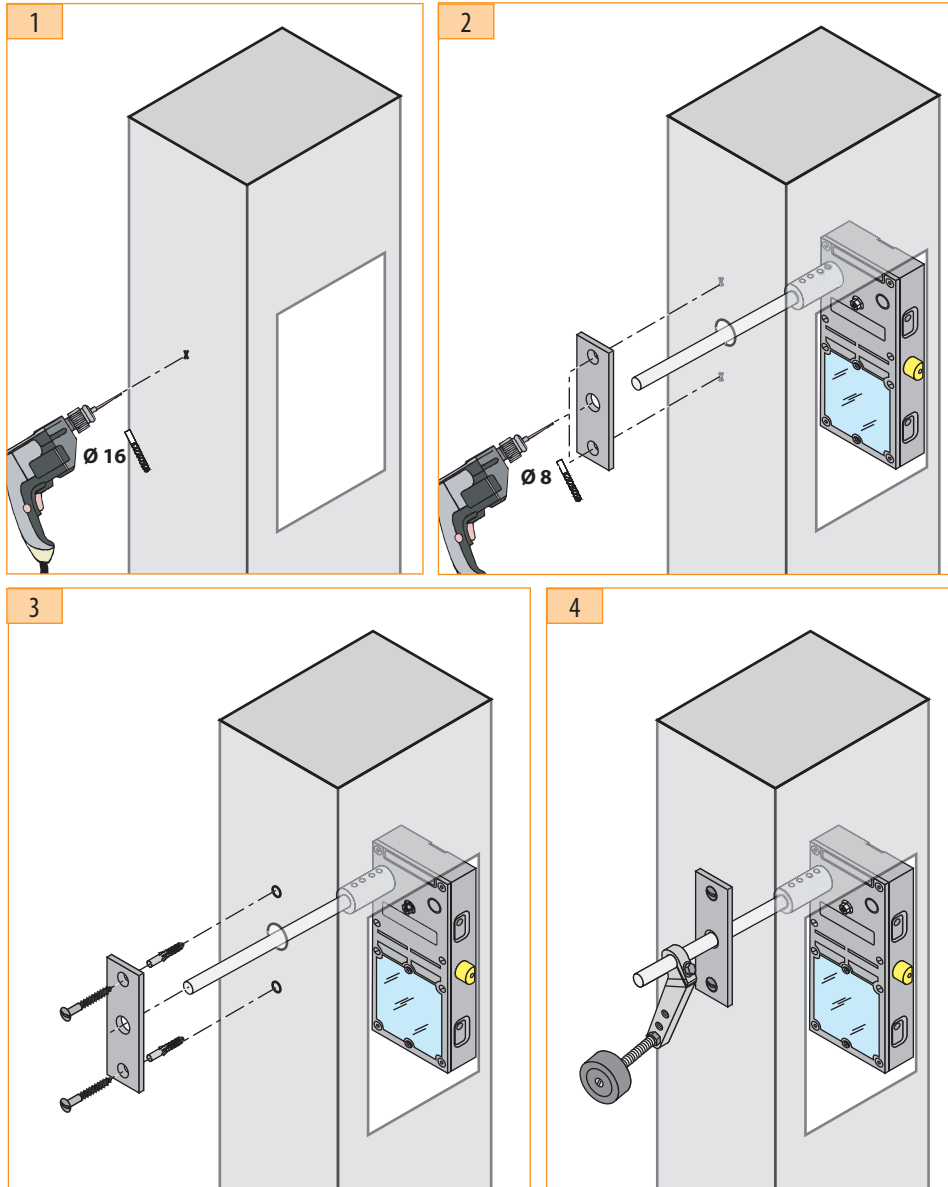

prudhomme S.a

38, Rue Charles de Gaulle F
94140 Paris/Alfortville
www.prudhomme.com
Tél. : +33 01 45 18 19 20
Fax : +33 01 45 18 19 21

NI-A Document non contractuel, sous réserve de modification - Reproduction interdite. NI Ind. A du 03/10/2012

Lengthens of lock axis

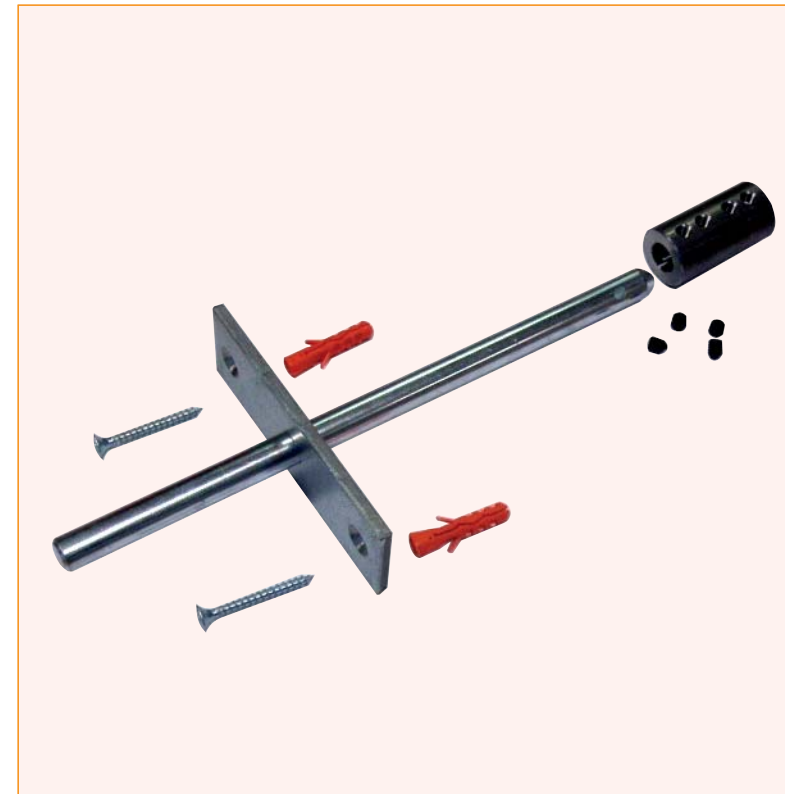

Supplies :

Set including : AD200 (x1) + AD199 (x1) + 180 0043-2 (x1) + STHC 5x5 (x4) + FSC 4x35 (2) + dowels 6x30 (x2).

Optional :

PLEASE, BEFORE INSTALLATION, READ IT CAREFULLY.

prudhomme S.a

Matériel spécifique pour ascenseurs - specific parts and components for elevators